

SYSTEM DESCRIPTION

SYSTEM CAPABLE OF SUPPORTING SPECIFIED ELECTRONICS.

PRE-ENGINEERED MODULAR CONSTRUCTION.

SUPPLIED KNOCKED-DOWN; ASSEMBLY ACCOMPLISHED WITHOUT NEED FOR WELDING OR MODIFICATIONS.

CONSTRUCTED OF STEEL SUPERSTRUCTURE FRAMEWORK CONSISTING OF END FRAMES CONNECTED BY HORIZONTAL MODESTY PANEL (STEEL SHEET INCORPORATING EASY-ACCESS CABLE RACEWAY).

TWO 1.5X3IN CABLE MANAGEMENT RACEWAYS PER WORK SURFACE, INTEGRATED CABLE CHANNEL IN BASE.

QUICK-RELEASE LIFT-OFF ACCESS PANELS LOCATED ON INSIDE OF EACH END FRAME.

COMPRISED OF STEEL END FRAMES WITH ELECTRIC-LIFT LEGS.

WORK SURFACES WITH INTEGRATED BLACK ANODIZED ALUMINUM VERSA-TRAK MOUNTING SYSTEM FOR LCD MONITOR ARRAYS.

ELECTRIC LIFT LEGS OPERATE AT 38MM/S AND ACCEPT 90LBS PER COLUMN.

WORK SURFACE HEIGHT ADJUSTMENT FROM 30 TO 46IN HIGH.

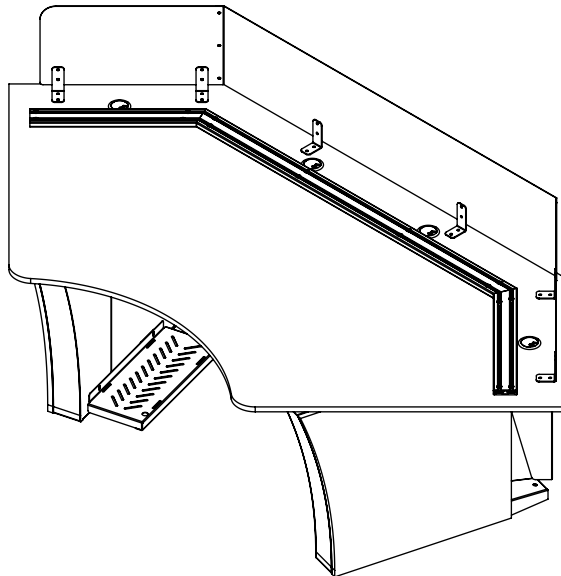

FRAME
BASE
FINISH
WORK SURFACE

END PANELS*

*MCF not available in Maple

LIFTING COLUMNS
POWER COMPATIBILITY
PRIVACY PANEL
CONTROL INTERFACE
FEATURES

- | | | | | | |
|---|---|-------------------------------|--------------------------------|---------------------------------|--------------------------------|
| <input checked="" type="checkbox"/> 36500 | <input checked="" type="checkbox"/> VUE C | | | | |
| <input checked="" type="checkbox"/> OPEN | <input checked="" type="checkbox"/> HEIGHT ADJUSTABLE | | | | |
| <input checked="" type="checkbox"/> BLACK POWDER COAT | | | | | |
| <input checked="" type="checkbox"/> SINGLE | | | | | |
| <input type="checkbox"/> 3/4" MDF | <input type="checkbox"/> 5/8" COMPACT LAMINATE | | | | |
| <input type="checkbox"/> BLACK | <input type="checkbox"/> WHITE | <input type="checkbox"/> GRAY | <input type="checkbox"/> MAPLE | <input type="checkbox"/> WALNUT | <input type="checkbox"/> OTHER |
| <input type="checkbox"/> 3/4" MCF | <input type="checkbox"/> 3/4" MDF | | | | |
| <input type="checkbox"/> BLACK | <input type="checkbox"/> WHITE | <input type="checkbox"/> GRAY | <input type="checkbox"/> MAPLE | <input type="checkbox"/> WALNUT | <input type="checkbox"/> OTHER |
| <input checked="" type="checkbox"/> TWO SETS OF TWO COLUMNS (4 TOTAL) | | | | | |
| <input type="checkbox"/> 110v | <input type="checkbox"/> 240v | | | | |
| <input type="checkbox"/> PERFORATED | <input type="checkbox"/> ACOUSTICAL LIGHTING | | | | |
| <input type="checkbox"/> ANALOG | <input type="checkbox"/> SYNERGY | | | | |
| <input checked="" type="checkbox"/> CPU PEDESTAL | | | | | |
| <input checked="" type="checkbox"/> VERSA-TRAK | | | | | |

WARRANTY

LIMITED LIFETIME WARRANTY ON ALL FIXED STEEL STRUCTURE FRAME COMPONENTS

10-YEAR WARRANTY ON ADJUSTABLE, SLIDING, OR HINGES COMPONENTS

10-YEAR WARRANTY ON LAMINATED SURFACES

5-YEAR WARRANTY ON POWER ACTUATED LIFT MECHANISMS

2-YEAR WARRANTY ON GENERAL ELECTRICAL COMPONENTS

36500 Vue C Open Base Sit-Stand

SCALE - NTS

winsted

The copyright of this drawing and design is vested solely in the Winsted Corporation. Reproduction of the document, in whole or in part, is prohibited other than with the express permission of the above company.

Sheet

1/4

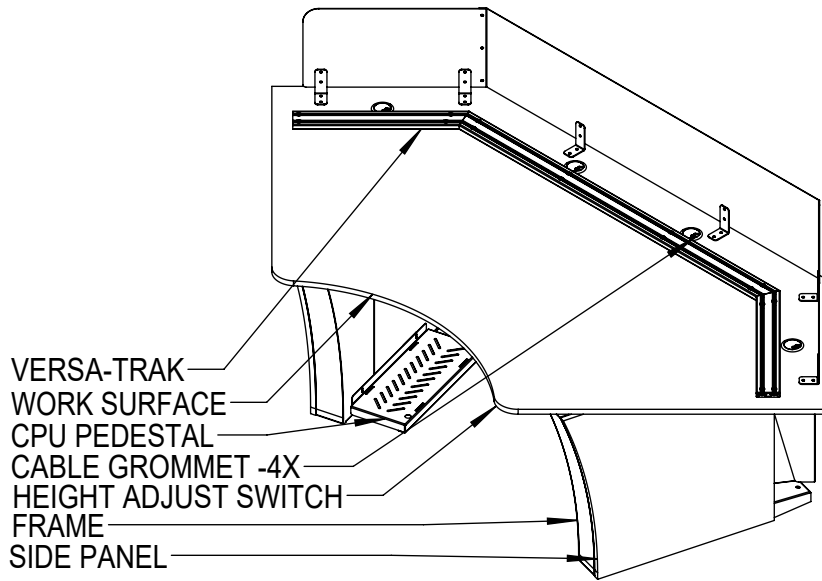

① Vue C Open Base Sit-Stand ISO-Front

PERFORATED
PRIVACY PANEL
MODESTY PANEL
CABLE GROMMET -9X
CABLE GROMMET -2X

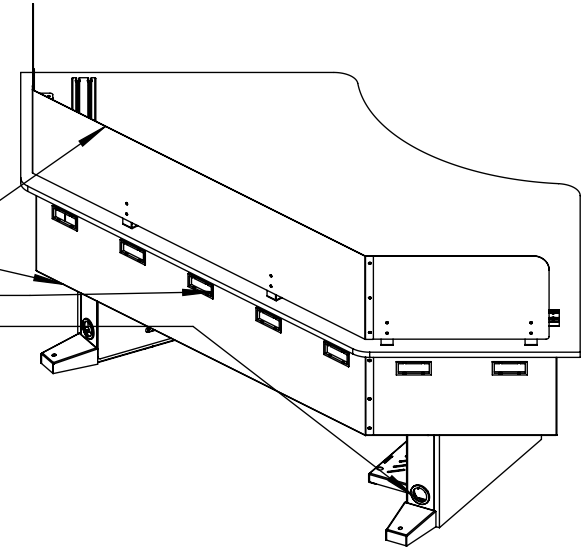

② Vue C Open Base Sit-Stand ISO-Back

NOTES:

- WORK SURFACES AVAILABLE IN 3/4" MDF OR 5/8" COMPACT LAMINATE (CL) CORE
- END PANELS AVAILABLE IN 3/4" MCF AND 3/4" MDF CORE
- APPLIES TO ALL SURFACES:
 - LAMINATE FACE COLORS ARE BLACK, WHITE, GRAY, MAPLE & WALNUT
 - MDF CUSTOM COLOR OPTIONS; REQUIRE CONTROL SAMPLE TO MATCH
 - CL CUSTOM COLORS MUST BE FROM FORMICA COLORECORE SERIES
 - MCF NOT AVAILABLE IN MAPLE
 - ARCHITECT TO SPECIFY GRAIN DIRECTION FOR MAPLE & WALNUT
- EDGE CONDITIONS (SECTION SHOWN ON SHEET 3, DETAIL 6)
 - WORK SURFACES
 - MDF: SAFEGUARD (T-MOLDED POLYETHYLENE PVC)
 - CL: MACHINE-SHAPED EXPOSED PHENOLIC RESIN CORE
 - PANELS
 - MCF: PVC EDGE-BANDING TO MATCH SURFACE COLOR
 - MDF: PVC EDGE-BANDING TO MATCH SURFACE COLOR

CABLE CHANNEL
ADJUSTABLE FEET
CABLE CHANNEL
FASTEN TO FLOOR

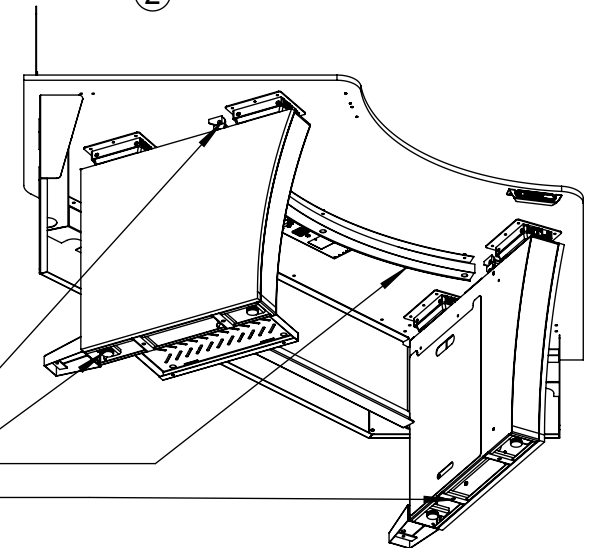

③ Vue C Open Base Sit-Stand ISO-Bottom

36500 Vue C Open Base Sit-Stand

SCALE - NTS

The copyright of this drawing and design is vested solely in the Winsted Corporation. Reproduction of the document, in whole or in part, is prohibited other than with the express permission of the above company.

Sheet

2
4

winsted

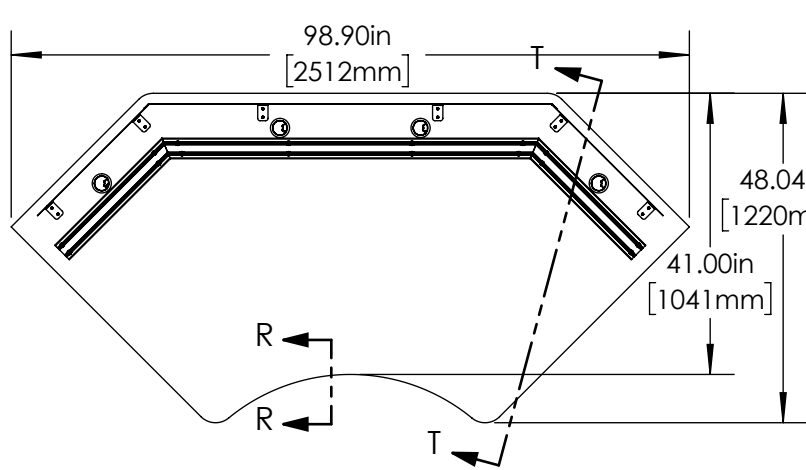

① Vue C Open Base Sit-Stand Top

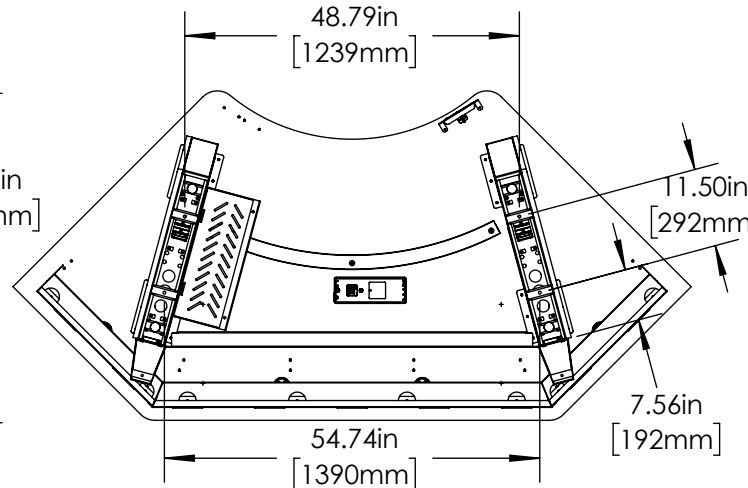

② Vue C Open Base Sit-Stand Bottom

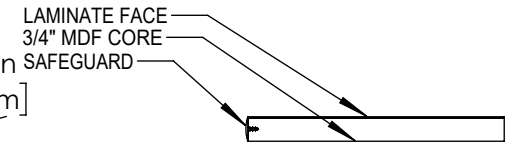

⑥ Section R-R - Edge Types Typical

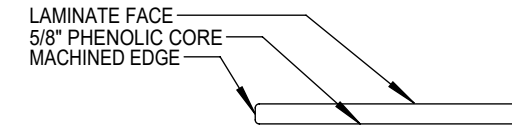

⑥ Section R-R - Edge Types Typical

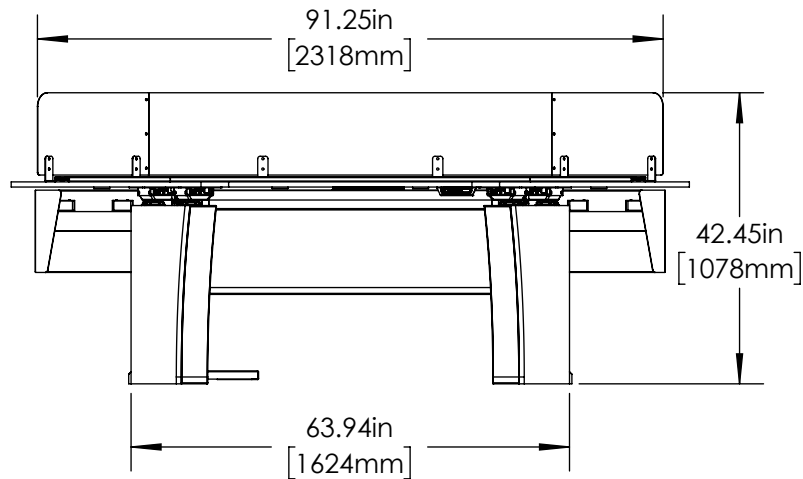

③ Vue C Open Base Sit-Stand Front

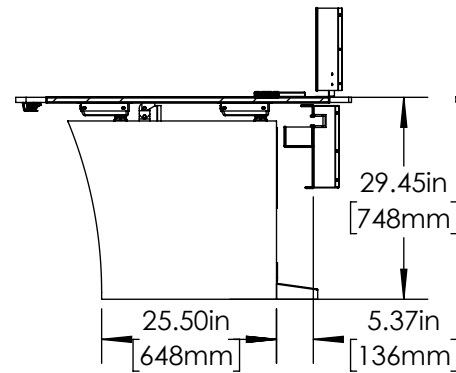

④ Section T-T - Vue C Open Base Sit-Stand Side

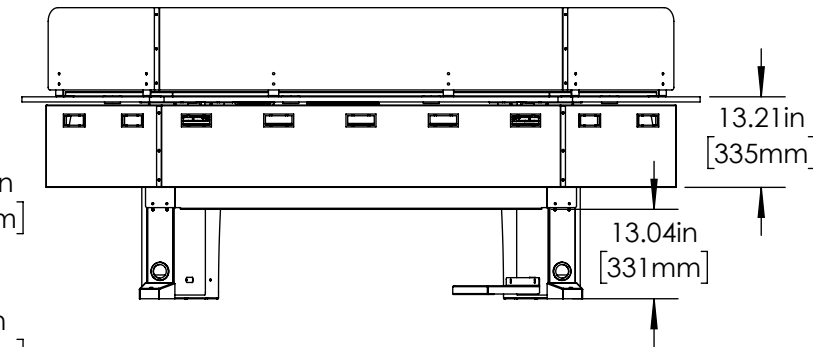

⑤ Vue C Open Base Sit/Stand Back



36500 Vue C Open Base Sit-Stand

SCALE - NTS

The copyright of this drawing and design is vested solely in the Winsted Corporation. Reproduction of the document, in whole or in part, is prohibited other than with the express permission of the above company.

Sheet

3/4

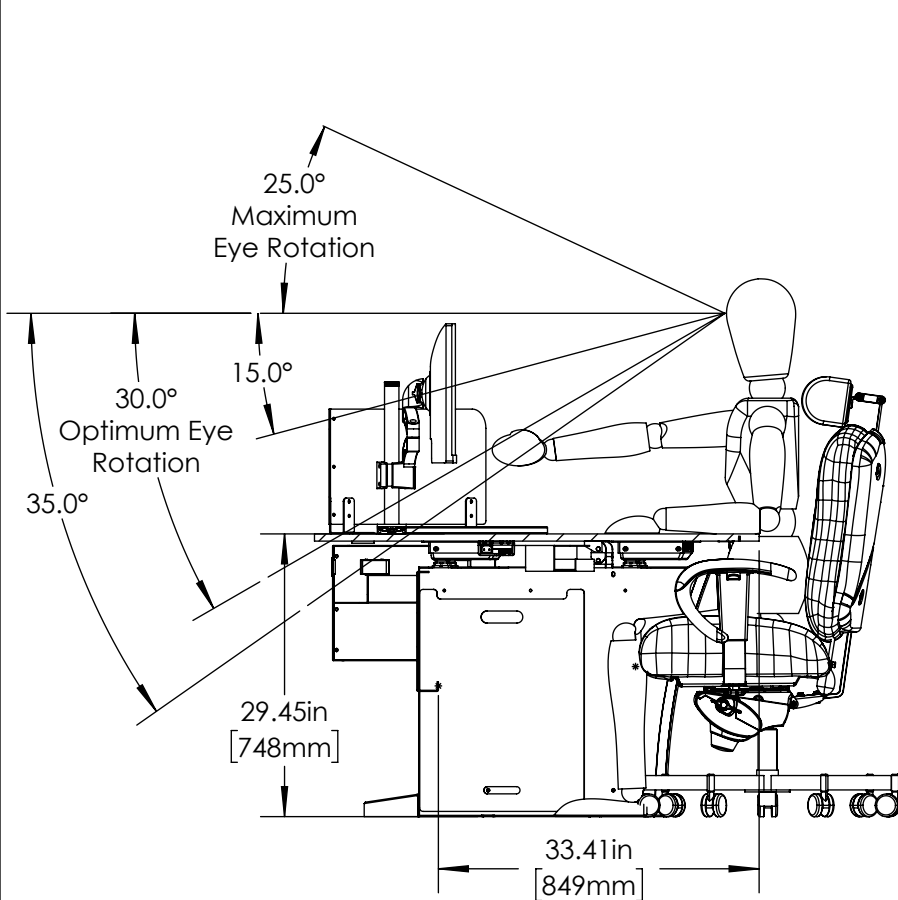

① Vue A Open Base Sit-Stand Ergonomic Detail - Sitting

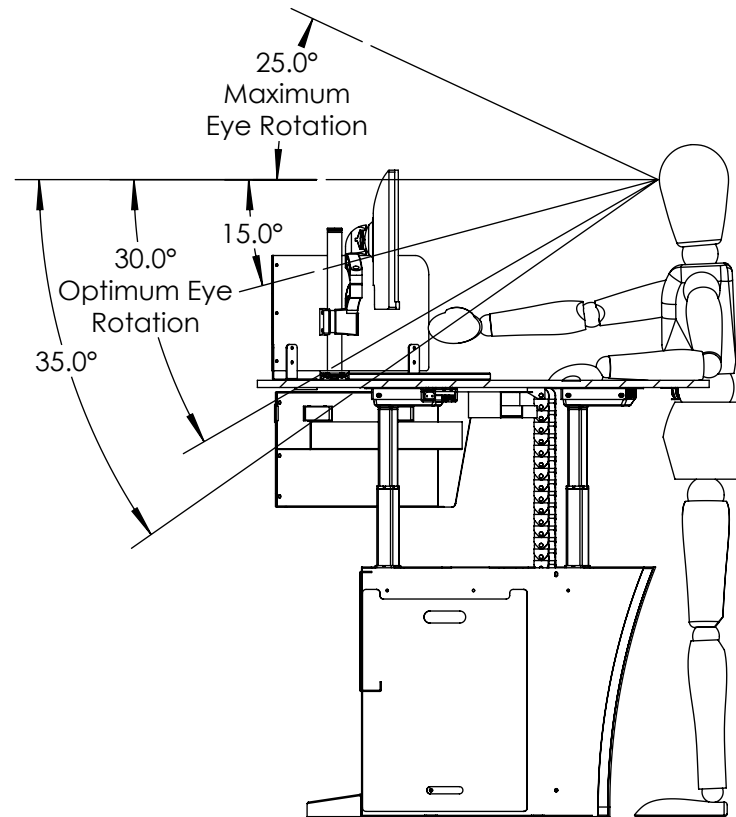

② Vue P Open Base Sit/Stand Ergonomic Detail - Standing



36500 Vue C Open Base Sit-Stand Ergonomic Details

SCALE - NTS

The copyright of this drawing and design is vested solely in the Winsted Corporation. Reproduction of the document, in whole or in part, is prohibited other than with the express permission of the above company.

Sheet

4/4