

## SYSTEM DESCRIPTION

SYSTEM CAPABLE OF SUPPORTING SPECIFIED ELECTRONICS.

PRE-ENGINEERED MODULAR CONSTRUCTION.

SUPPLIED KNOCKED-DOWN; ASSEMBLY ACCOMPLISHED WITHOUT NEED FOR WELDING OR MODIFICATIONS.

CONSTRUCTED OF STEEL SUPERSTRUCTURE FRAMEWORK CONSISTING OF END FRAMES CONNECTED BY HORIZONTAL MODESTY PANEL (STEEL SHEET INCORPORATING EASY-ACCESS CABLE RACEWAY).

TWO 1.5X3IN CABLE MANAGEMENT RACEWAYS PER WORK SURFACE, INTEGRATED CABLE CHANNEL IN BASE.

QUICK-RELEASE LIFT-OFF ACCESS PANELS LOCATED ON INSIDE OF EACH END FRAME.

COMPRISED OF STEEL END FRAMES WITH ELECTRIC-LIFT LEGS.

WORK SURFACES WITH INTEGRATED BLACK ANODIZED ALUMINUM VERSA-TRAK MOUNTING SYSTEM FOR LCD MONITOR ARRAYS.

ELECTRIC LIFT LEGS OPERATE AT 38MM/S AND ACCEPT 90LBS PER COLUMN.

WORK SURFACE HEIGHT ADJUSTMENT FROM 30 TO 46IN HIGH.

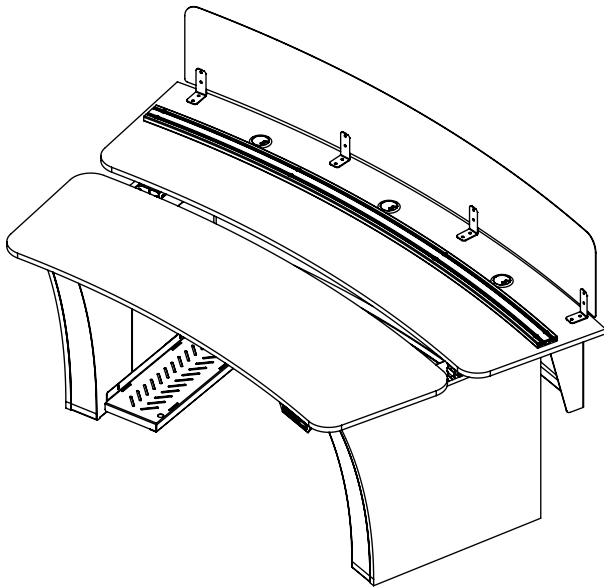

FRAME

BASE

FINISH

WORK SURFACE

END PANELS\*

*\*MCF not available in Maple*

LIFTING COLUMNS

POWER COMPATIBILITY

PRIVACY PANEL

CONTROL INTERFACE

FEATURES

☒ 36320

☒ OPEN

☒ BLACK POWDER COAT

☒ DUAL

☐ 3/4" MDF

☐ BLACK

☐ 3/4" MCF

☐ BLACK

☒ TWO SETS OF TWO COLUMNS (4 TOTAL)

☐ 110v

☐ PERFORATED

☐ ANALOG

☒ CPU PEDESTAL

☒ VERSA-TRAK

VUE P

☒ HEIGHT ADJUSTABLE

☐ 5/8" COMPACT LAMINATE

☐ WHITE

☐ 3/4" MDF

☐ WHITE

☐ 240v

☐ GRAY

☐ GRAY

☐ ACOUSTICAL LIGHTING

☐ SYNERGY

☐ MAPLE

☐ MAPLE

☐ WALNUT

☐ WALNUT

☐ OTHER

☐ OTHER

## WARRANTY

LIMITED LIFETIME WARRANTY ON ALL FIXED STEEL STRUCTURE FRAME COMPONENTS

10-YEAR WARRANTY ON ADJUSTABLE, SLIDING, OR HINGES COMPONENTS

10-YEAR WARRANTY ON LAMINATED SURFACES

5-YEAR WARRANTY ON POWER ACTUATED LIFT MECHANISMS

2-YEAR WARRANTY ON GENERAL ELECTRICAL COMPONENTS

# 36320 Vue P Open Base Dual Sit-Stand

SCALE - NTS

The copyright of this drawing and design is vested solely in the Winsted Corporation. Reproduction of the document, in whole or in part, is prohibited other than with the express permission of the above company.

Sheet

1/4

winsted

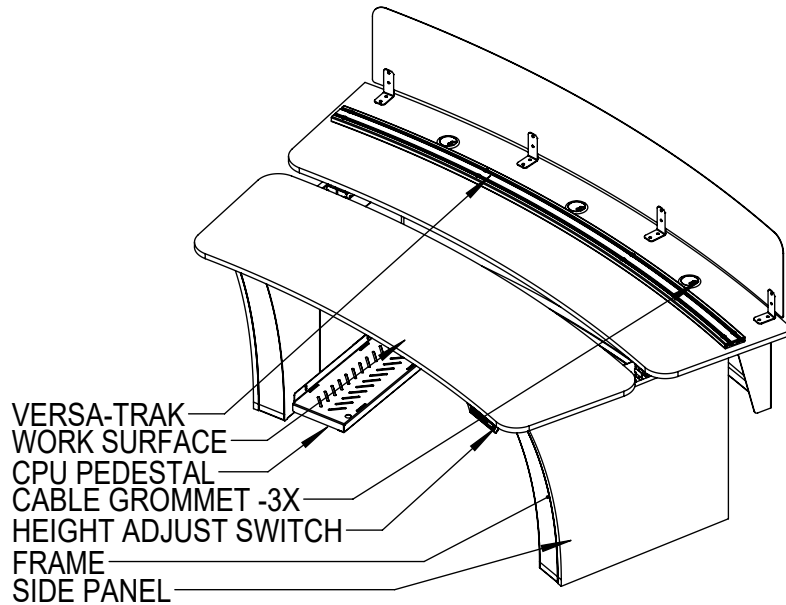

① Vue P Open Base Dual Sit-Stand ISO-Front

NOTES:

- WORK SURFACES AVAILABLE IN 3/4" MDF OR 5/8" COMPACT LAMINATE (CL) CORE
- END PANELS AVAILABLE IN 3/4" MCF AND 3/4" MDF CORE
- APPLIES TO ALL SURFACES:
  - LAMINATE FACE COLORS ARE BLACK, WHITE, GRAY, MAPLE & WALNUT
  - MDF CUSTOM COLOR OPTIONS; REQUIRE CONTROL SAMPLE TO MATCH
  - CL CUSTOM COLORS MUST BE FROM FORMICA COLORECORE SERIES
  - MCF NOT AVAILABLE IN MAPLE
  - ARCHITECT TO SPECIFY GRAIN DIRECTION FOR MAPLE & WALNUT
- EDGE CONDITIONS (SECTION SHOWN ON SHEET 3, DETAIL 6)
  - WORK SURFACES
    - MDF: SAFEGUARD (T-MOLDED POLYETHYLENE PVC)
    - CL: MACHINE-SHAPED EXPOSED PHENOLIC RESIN CORE
  - PANELS
    - MCF: PVC EDGE-BANDING TO MATCH SURFACE COLOR
    - MDF: PVC EDGE-BANDING TO MATCH SURFACE COLOR

PERFORATED  
PRIVACY PANEL  
MODESTY PANEL  
CABLE GROMMET -5X  
CABLE GROMMET -2X

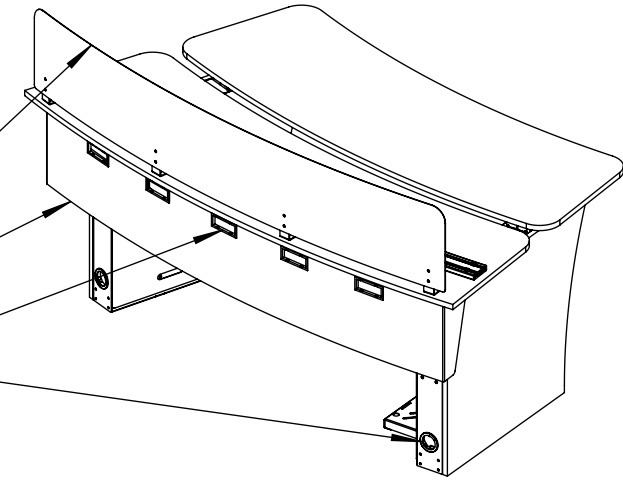

② Vue P Open Base Dual Sit-Stand ISO-Back

CABLE CHANNEL  
ADJUSTABLE FEET  
CABLE CHANNEL  
FASTEN TO FLOOR

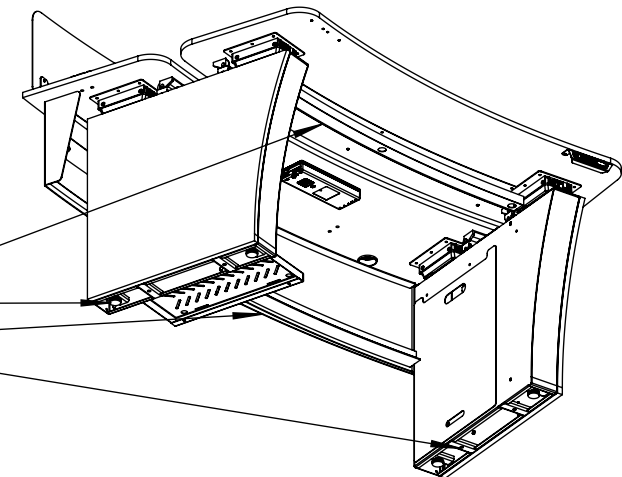

③ Vue P Open Base Dual Sit-Stand ISO-Bottom

# 36320 Vue P Open Base Dual Sit-Stand

SCALE - NTS

The copyright of this drawing and design is vested solely in the Winsted Corporation. Reproduction of the document, in whole or in part, is prohibited other than with the express permission of the above company.

Sheet

2  
4

winsted

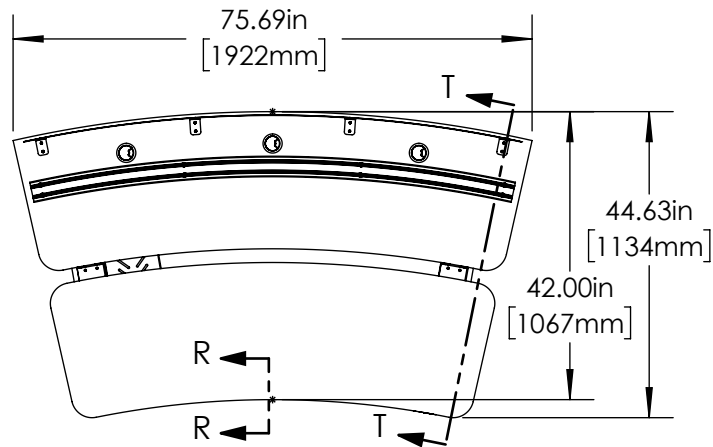

① Vue P Open Base Dual Sit-Stand Top

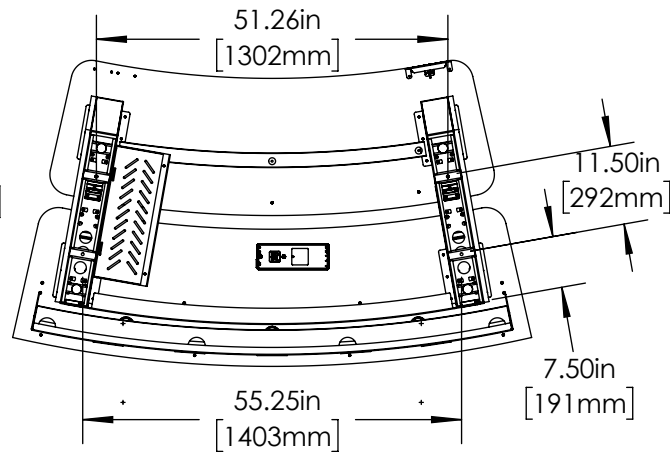

② Vue P Open Base Dual Sit-Stand Bottom

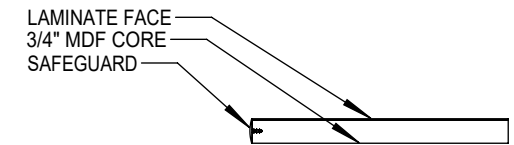

⑥ Section R-R - Edge Types Typical

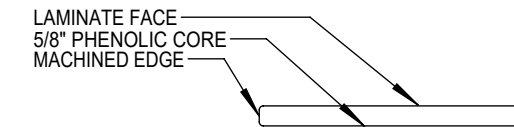

⑥ Section R-R - Edge Types Typical

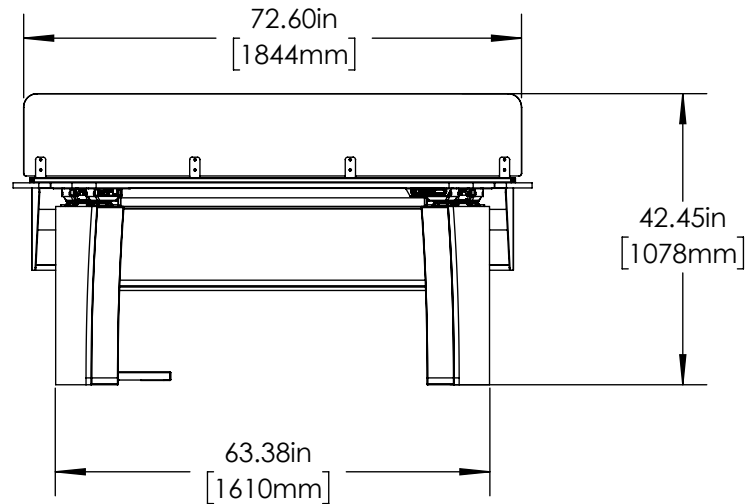

③ Vue P Open Base Dual Sit-Stand Front

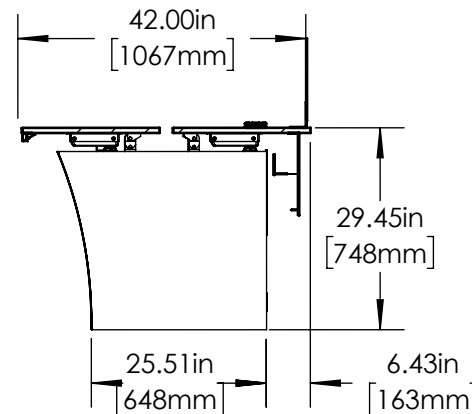

④ Section T-T - Vue P Open Base Dual Sit-Stand Side

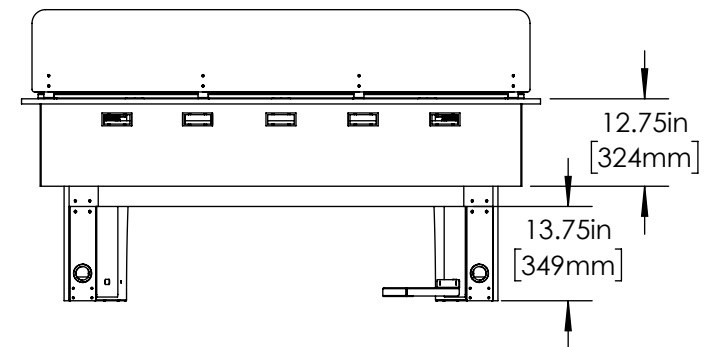

⑤ Vue P Open Base Dual Sit-Stand Back



# 36320 Vue P Open Base Dual Sit-Stand

SCALE - NTS

The copyright of this drawing and design is vested solely in the Winsted Corporation. Reproduction of the document, in whole or in part, is prohibited other than with the express permission of the above company.

Sheet

3/4

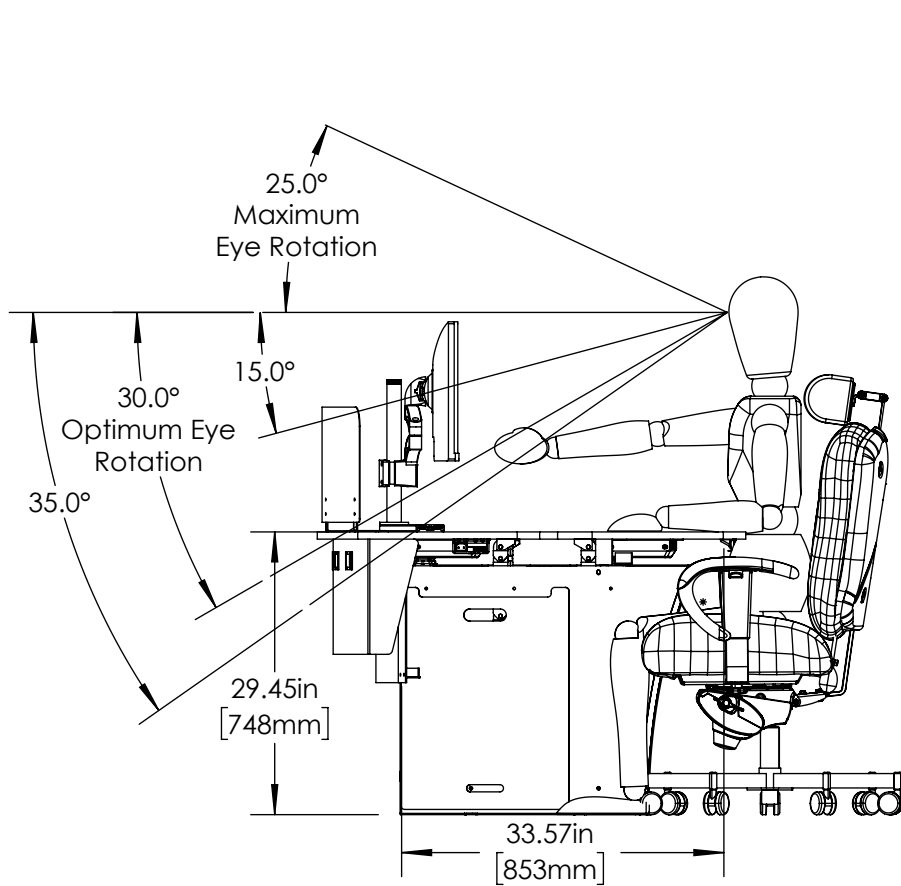

① Vue P Open Base Dual Sit-Stand Ergonomic Detail - Sitting

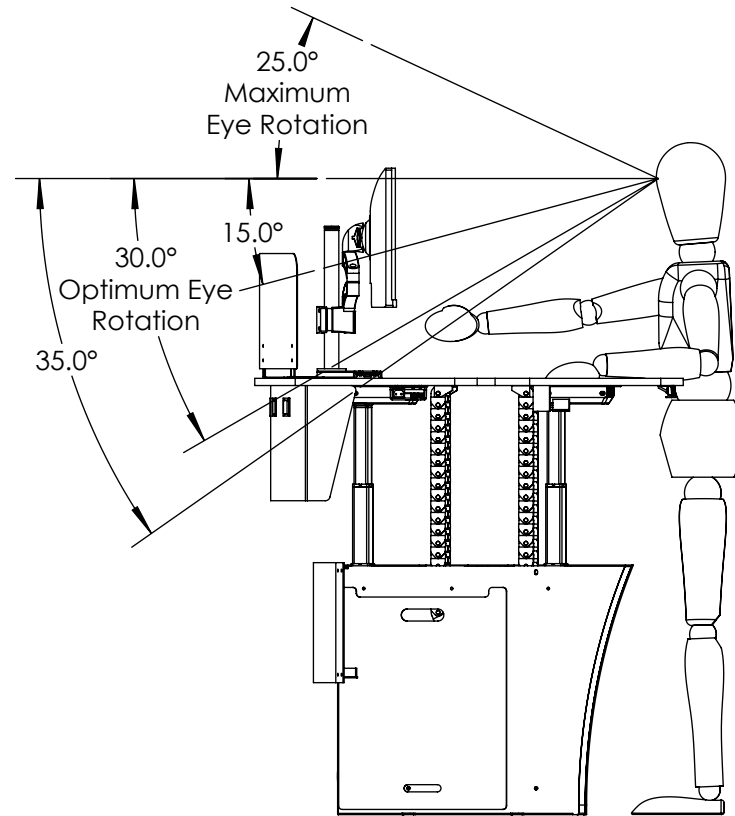

② Vue P Open Base Dual Sit-Stand Ergonomic Detail - Standing



# 36320 Vue P Open Base Dual Sit-Stand Ergonomic Details

SCALE - NTS

The copyright of this drawing and design is vested solely in the Winsted Corporation. Reproduction of the document, in whole or in part, is prohibited other than with the express permission of the above company.

Sheet

4/4