

SYSTEM DESCRIPTION

SYSTEM CAPABLE OF SUPPORTING SPECIFIED ELECTRONICS.

PRE-ENGINEERED MODULAR CONSTRUCTION.

SUPPLIED KNOCKED-DOWN; ASSEMBLY ACCOMPLISHED WITHOUT NEED FOR WELDING OR MODIFICATIONS.

CONSTRUCTED OF STEEL SUPERSTRUCTURE FRAMEWORK CONSISTING OF END FRAMES CONNECTED BY HORIZONTAL MODESTY PANEL (STEEL SHEET INCORPORATING EASY-ACCESS CABLE RACEWAY).

TWO 1.5X3IN CABLE MANAGEMENT RACEWAYS PER WORK SURFACE, INTEGRATED CABLE CHANNEL IN BASE.

QUICK-RELEASE LIFT-OFF ACCESS PANELS LOCATED ON INSIDE OF EACH END FRAME.

COMPRISED OF STEEL END FRAMES WITH ELECTRIC-LIFT LEGS.

WORK SURFACES WITH INTEGRATED BLACK ANODIZED ALUMINUM VERSA-TRAK MOUNTING SYSTEM FOR LCD MONITOR ARRAYS.

ELECTRIC LIFT LEGS OPERATE AT 38MM/S AND ACCEPT 90LBS PER COLUMN.

WORK SURFACE HEIGHT ADJUSTMENT FROM 30 TO 46IN HIGH.

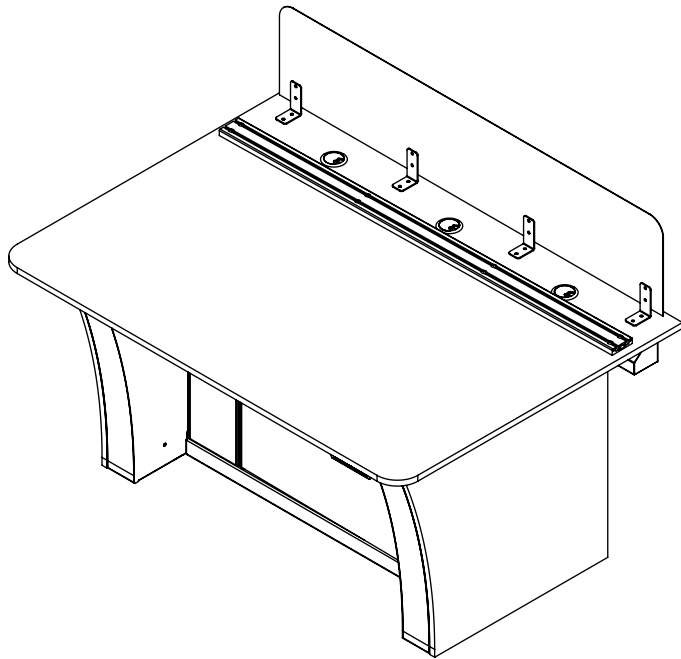

FRAME
BASE
FINISH
WORK SURFACE

END PANELS*

**MCF not available in Maple*

LIFTING COLUMNS

POWER COMPATIBILITY

PRIVACY PANEL

CONTROL INTERFACE

FEATURES

<input checked="" type="checkbox"/> 36150	<input checked="" type="checkbox"/> VUE L				
<input checked="" type="checkbox"/> CLOSED	<input checked="" type="checkbox"/> HEIGHT ADJUSTABLE				
<input checked="" type="checkbox"/> BLACK POWDER COAT					
<input checked="" type="checkbox"/> SINGLE					
<input type="checkbox"/> 3/4" MDF	<input type="checkbox"/> 5/8" COMPACT LAMINATE				
<input type="checkbox"/> BLACK	<input type="checkbox"/> WHITE	<input type="checkbox"/> GRAY	<input type="checkbox"/> MAPLE	<input type="checkbox"/> WALNUT	<input type="checkbox"/> OTHER
<input type="checkbox"/> 3/4" MCF	<input type="checkbox"/> 3/4" MDF				
<input type="checkbox"/> BLACK	<input type="checkbox"/> WHITE	<input type="checkbox"/> GRAY	<input type="checkbox"/> MAPLE	<input type="checkbox"/> WALNUT	<input type="checkbox"/> OTHER
<input checked="" type="checkbox"/> ONE SET OF TWO COLUMNS (2 TOTAL)					
<input type="checkbox"/> 110v	<input type="checkbox"/> 240v				
<input type="checkbox"/> PERFORATED		<input type="checkbox"/> ACOUSTICAL LIGHTING			
<input type="checkbox"/> ANALOG		<input type="checkbox"/> SYNERGY			
<input checked="" type="checkbox"/> CPU SHELF					
<input checked="" type="checkbox"/> VERSA-TRAK					
<input checked="" type="checkbox"/> LAMINATE FRONT DOORS	<input checked="" type="checkbox"/> SOFT TOUCH LATCH	<input checked="" type="checkbox"/> LOCKABLE			
<input checked="" type="checkbox"/> STEEL VENTED REAR DOORS	<input checked="" type="checkbox"/> SOFT TOUCH LATCH	<input checked="" type="checkbox"/> LOCKABLE			
<input checked="" type="checkbox"/> 11U RACKING BASE CABINET					

WARRANTY

LIMITED LIFETIME WARRANTY ON ALL FIXED STEEL STRUCTURE FRAME COMPONENTS

10-YEAR WARRANTY ON ADJUSTABLE, SLIDING, OR HINGES COMPONENTS

10-YEAR WARRANTY ON LAMINATED SURFACES

5-YEAR WARRANTY ON POWER ACTUATED LIFT MECHANISMS

2-YEAR WARRANTY ON GENERAL ELECTRICAL COMPONENTS

36150 Vue L Closed Base Sit-Stand

SCALE - NTS

winsted

The copyright of this drawing and design is vested solely in the Winsted Corporation. Reproduction of the document, in whole or in part, is prohibited other than with the express permission of the above company.

Sheet

1/4

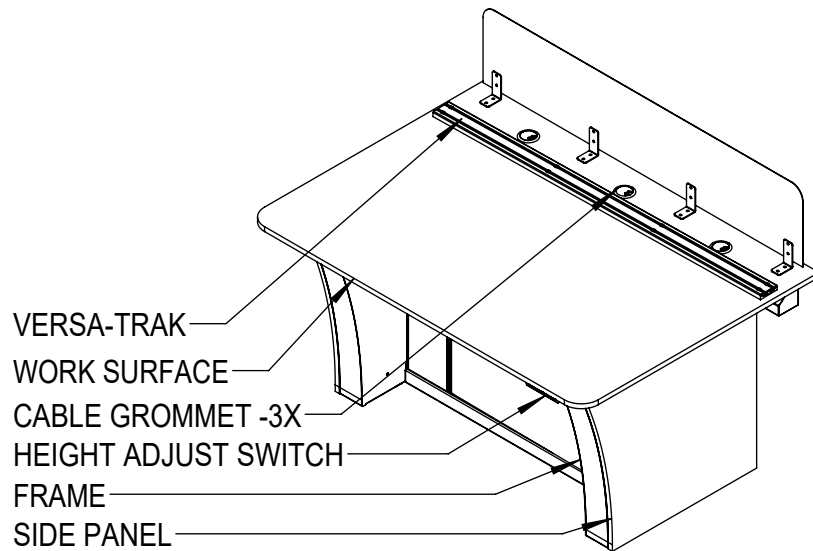

① Vue L Closed Base Sit/Stand ISO-Front

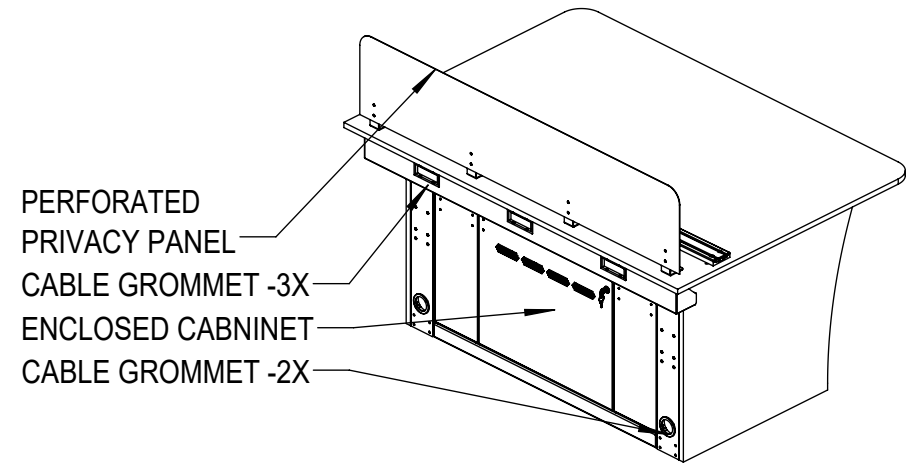

② Vue L Closed Base Sit/Stand ISO-Back

NOTES:

- WORK SURFACES AVAILABLE IN 3/4" MDF OR 5/8" COMPACT LAMINATE (CL) CORE
- END PANELS AND DOORS AVAILABLE IN 3/4" MCF AND 3/4" MDF CORE
- APPLIES TO ALL SURFACES:
 - LAMINATE FACE COLORS ARE BLACK, WHITE, GRAY, MAPLE & WALNUT
 - MDF CUSTOM COLOR OPTIONS; REQUIRE CONTROL SAMPLE TO MATCH
 - CL CUSTOM COLORS MUST BE FROM FORMICA COLORECORE SERIES
 - MCF NOT AVAILABLE IN MAPLE
 - ARCHITECT TO SPECIFY GRAIN DIRECTION FOR MAPLE & WALNUT
- EDGE CONDITIONS (SECTION SHOWN ON SHEET 3, DETAIL 6)
 - WORK SURFACES
 - MDF: SAFEGUARD (T-MOLDED POLYETHYLENE PVC)
 - CL: MACHINE-SHAPED EXPOSED PHENOLIC RESIN CORE
 - PANELS AND DOORS:
 - MCF: PVC EDGE-BANDING TO MATCH SURFACE COLOR
 - MDF: PVC EDGE-BANDING TO MATCH SURFACE COLOR

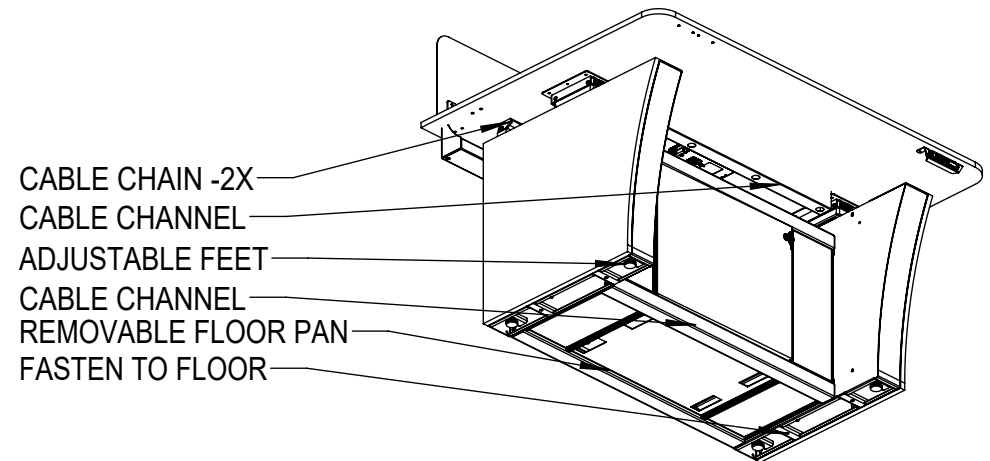

③ Vue L Closed Base Sit/Stand ISO-Bottom

36150 Vue L Closed Base Sit-Stand

SCALE - NTS

The copyright of this drawing and design is vested solely in the Winsted Corporation. Reproduction of the document, in whole or in part, is prohibited other than with the express permission of the above company.

Sheet

2/4

winsted

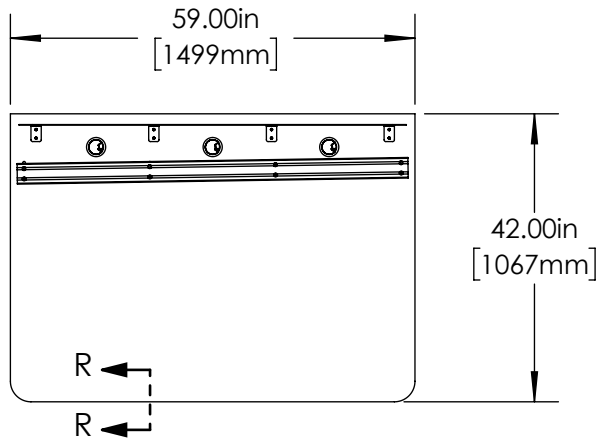

① Vue L Closed Base Sit/Stand Top

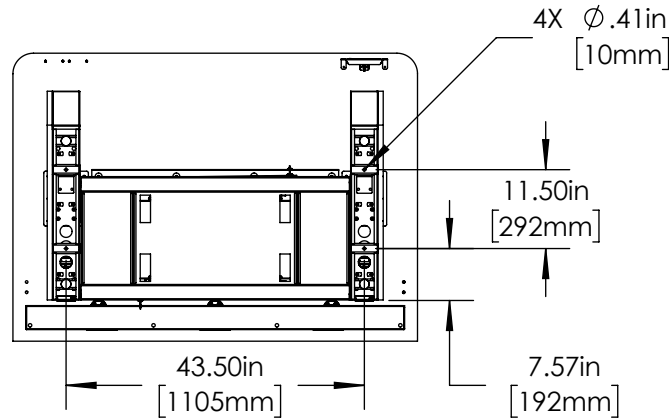

② Vue L Closed Base Sit/Stand Bottom

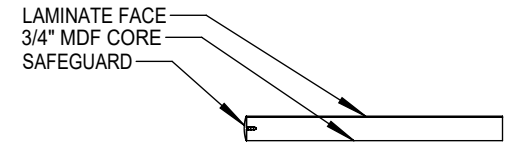

⑥ Section R-R - Edge Types Typical

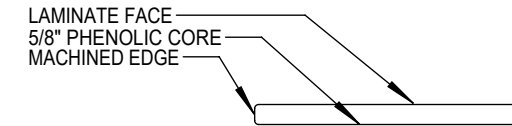

⑥ Section R-R - Edge Types Typical

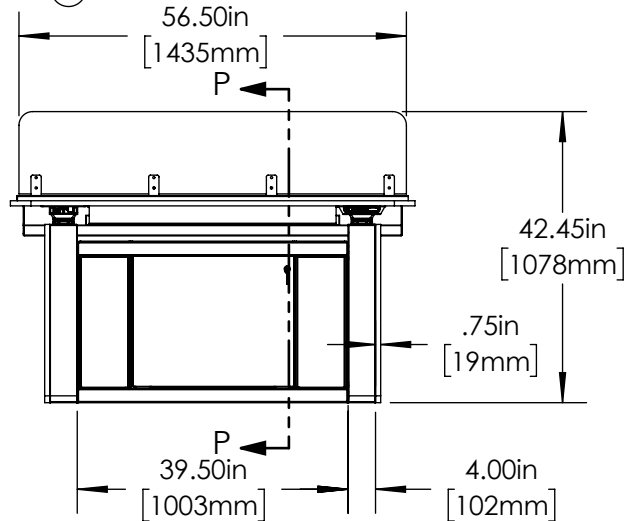

③ Vue L Closed Base Sit/Stand Front

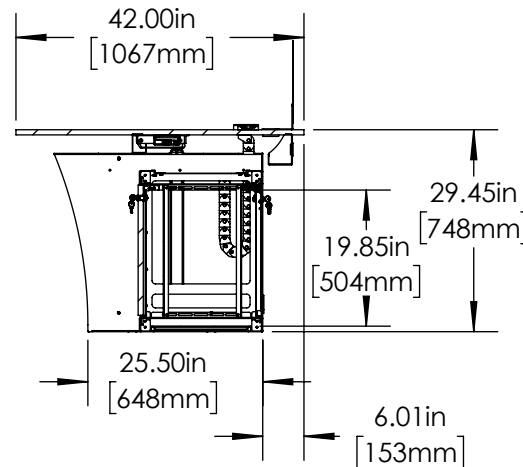

④ Section P-P - Vue L Closed Base Sit/Stand Side

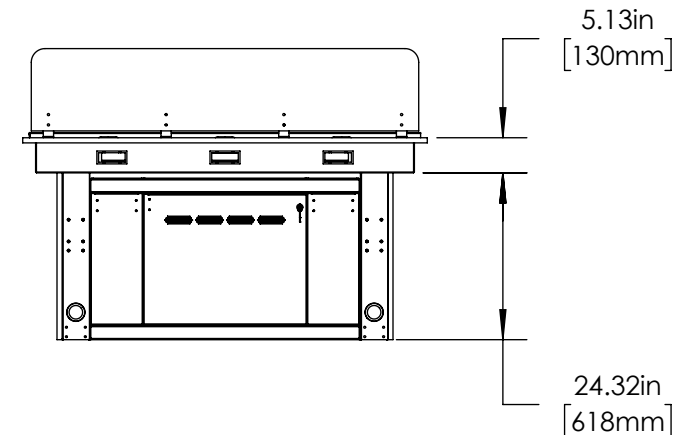

⑤ Vue L Closed Base Sit/Stand Back



36150 Vue L Closed Base Sit-Stand

SCALE - NTS

The copyright of this drawing and design is vested solely in the Winsted Corporation. Reproduction of the document, in whole or in part, is prohibited other than with the express permission of the above company.

Sheet

3/4

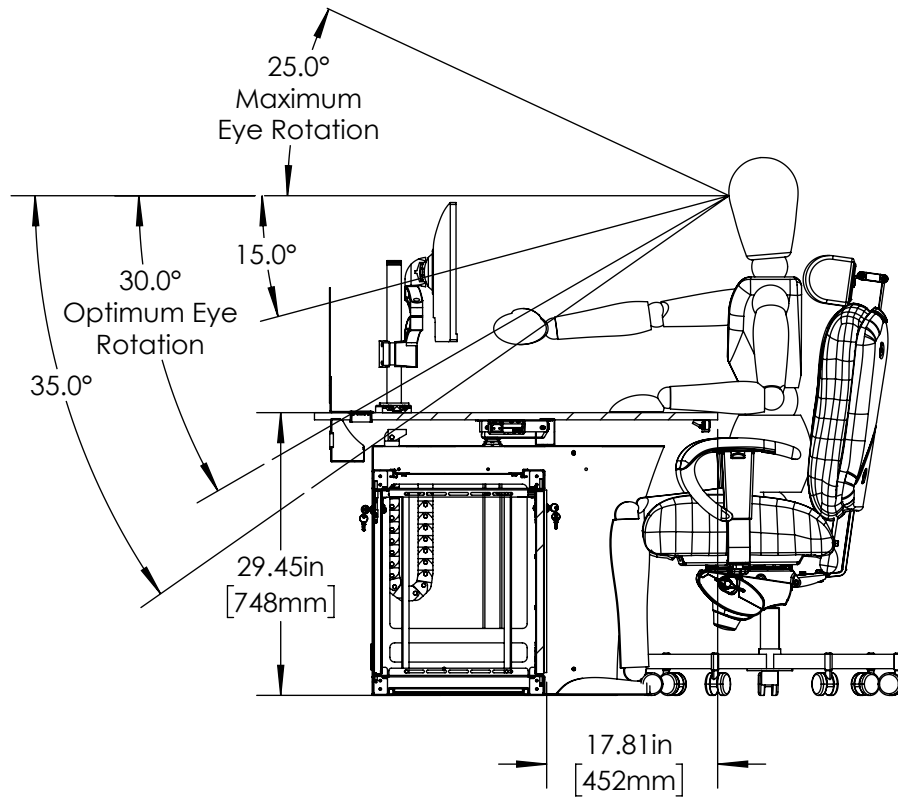

① Vue L Closed Base Sit/Stand Ergonomic Detail - Sitting

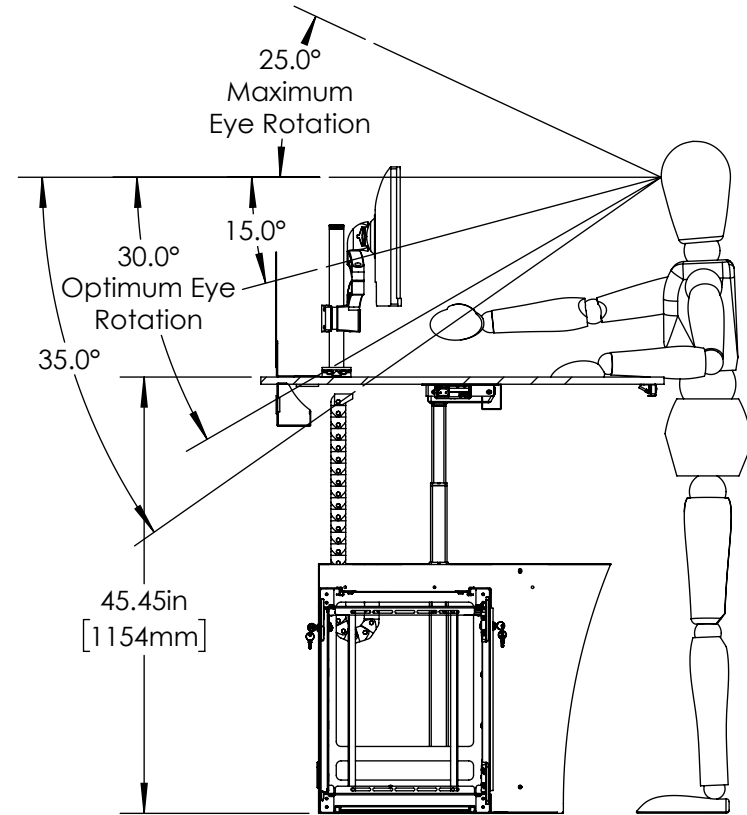

② Vue L Closed Base Sit/Stand Ergonomic Detail - Standing



36150 Vue L Closed Base Sit-Stand Ergonomic Details

SCALE - NTS

The copyright of this drawing and design is vested solely in the Winsted Corporation. Reproduction of the document, in whole or in part, is prohibited other than with the express permission of the above company.

Sheet

4 / 4